

APPLICATIONS

Designed for professional power electronics by segmented and slope metallization.
 Low, Medium and High frequencies switching.
 Solar converters, Motor drives, Traction applications, Inverters, Welding.

GENERAL INFORMATION

Reference	IEC 61071-1
IEC climatic	40/85/21 IEC 68-1
Storage temperature	-40 to +90°C
Temperature range	-40 to +85°C
Case	Aluminium case with or without stud M12
Maximum screw torque strength for stud M12	8 Nm
Deck	Plastic deck UL94 (V0)
Insert style of deck	High current M6 female terminals, M8 male terminals
Maximum screw torque strength for insert	3Nm x M6, 6Nm x M8,
Dielectric	Self healing polypropylene film
Filling	Self-extinguishing (V0) polyurethane resin
Surge voltage between terminals	X1.5 10sec 25°C
Test voltage terminal to case	4KV 50Hz for 2 sec
Capacitance deviation range temperature	±1.5% @ 25°C
Tolerance (digit 12th)	"K" = -10%, +10% "J" = -5% +5% under request
Mounting	Horizontal – vertical
Maximum ripple current	100A
Max dV/dt not repetitive peak	≤ 40 V/μsec
Life	100000 H - Nominal Voltage @ 85°C
Failure Rate	300 FIT
Damp Heat test	Stable electrical parameters in humidity ambient conditions 85°C; 85% RH, Nominal voltage applied, 1000 Hours
Expected life estimation based on application conditions and our life formula	Please contact our technical service.
End life criteria	±10% cap

MECHANICAL SPECIFICATIONS

M6 STANDARD FEMALE STYLE

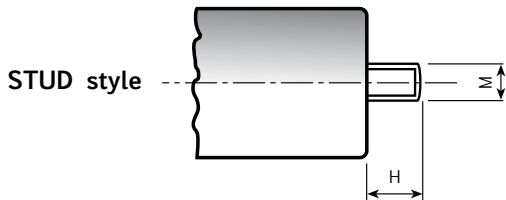
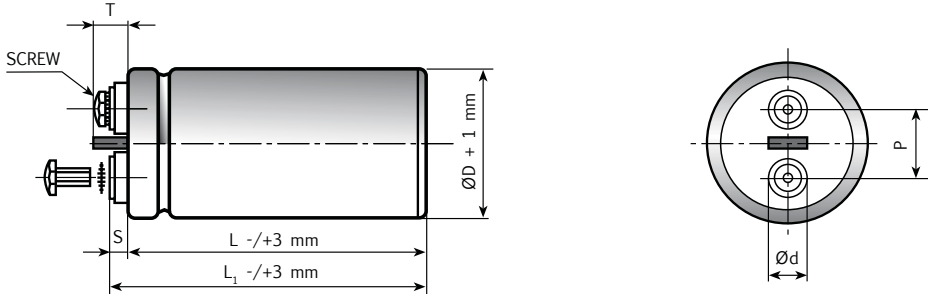

M6 LONG FEMALE STYLE

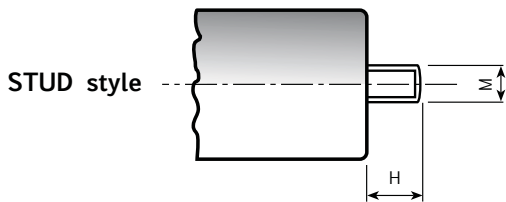
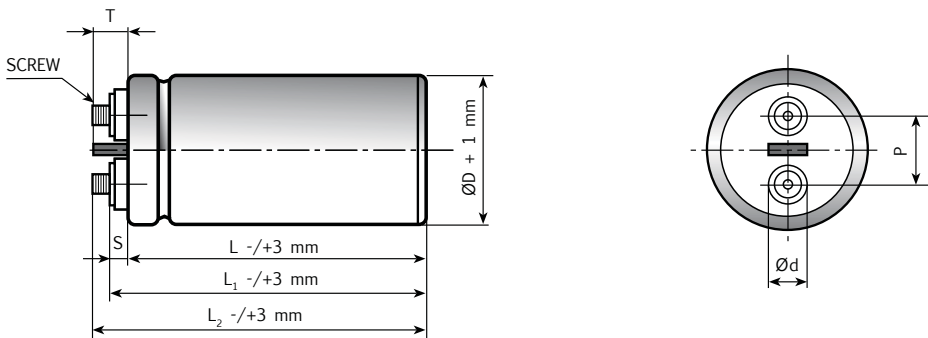

Diagram of dimensions (unit=mm)

K32 TYPE -40°C +85°C

M8 MALE STYLE

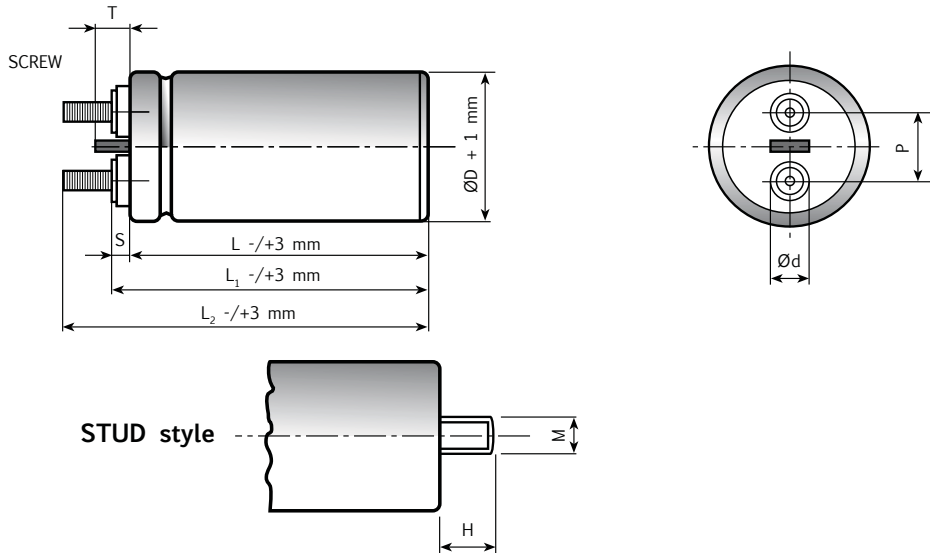

Diagram of dimensions (unit=mm)

ØD	d	P	M	H	T	L ₁ - L	L ₂ - L	L ₂ - L ₁
75 male	22.20	31.8	M12	16	11	9	29	20
85 male	22.20	31.8	M12	16	11	9	29	20
75 female M6	22.20	31.8	M12	16	11	9	Not defined	
85 female M6	22.20	31.8	M12	16	11	9	Not defined	
75 female M6 long	22.20	31.8	M12	16	11	9	14	5
85 female M6 long	22.20	31.8	M12	16	11	9	14	5

K32 TYPE STANDARD RATINGS

Cap. μF	Ø x L Mm	ESR mΩ 10 KHz	ESL nH	Rth °C/W	I _r a.c. A max 10K Hz 40°C	I _r a.c. A max 10K Hz 60°C	I _r a.c. A max 10KHz 75°C	dV/dt V/μsec	I _{pk} A	PART NUMBER Termination digit excluded
450	75x120	1.8	35	5.2	61	46	29	7.0	3146	K32600451_KOJ120
550	75x140	1.9	35	4.6	63	48	30	6.3	3465	K32600551_KOJ140
600	85x120	1.9	40	4.4	64	49	31	7.0	4194	K32600601_KOL120
650	75x155	2.0	35	4.1	65	49	31	6.3	4095	K32600651_KOJ155
750	85x140	2.3	40	3.9	63	47	30	6.3	4725	K32600751_KOL140
850	85x155	2.4	40	3.4	65	50	31	6.3	5355	K32600851_KOL155
1000	85x155	2.4	40	3.4	65	50	31	6.3	5670	K32600102_KOL155*

**RATED
VOLTAGE
VDC**

600V

***Notes: Not available by 5% of tolerances.**

Cap. μF	Ø x L Mm	ESR mΩ 10 KHz	ESL nH	Rth °C/W	I _r a.c. A max 10K Hz 40°C	I _r a.c. A max 10K Hz 60°C	I _r a.c. A max 10KHz 75°C	dV/dt V/μsec	I _{pk} A	PART NUMBER Termination digit excluded
350	75x120	1.8	35	5.2	61	46	29	8.2	2854	K32700351_KOJ120
420	75x140	1.9	35	4.6	63	48	30	7.4	3087	K32700421_KOJ140
450	85x120	1.7	40	4.4	69	52	33	8.2	3670	K32700451_KOL120
500	75x155	1.7	35	4.1	71	54	34	7.4	3675	K32700501_KOJ155
550	85x140	1.6	40	3.9	76	57	36	7.4	4043	K32700551_KOL140
600	85x155	1.8	40	3.4	76	57	36	7.4	4410	K32700601_KOL155

**RATED
VOLTAGE
VDC**

700V

Cap. μF	Ø x L Mm	ESR mΩ 10 KHz	ESL nH	Rth °C/W	I _r a.c. A max 10K Hz 40°C	I _r a.c. A max 10K Hz 60°C	I _r a.c. A max 10KHz 75°C	dV/dt V/μsec	I _{pk} A	PART NUMBER Termination digit excluded
220	75x120	2.3	35	5.2	54	41	26	9.3	2050	K32900221_KOJ120
270	75x140	2.0	35	4.6	63	48	30	8.4	2268	K32900271_KOJ140
300	75x155	2.0	35	4.1	65	49	31	8.4	2520	K32900301_KOJ155
300	85x120	2.0	40	4.4	69	52	33	9.3	2796	K32900301_KOL120
350	85x140	2.1	40	3.9	66	50	32	8.4	2940	K32900351_KOL140
350	75x155	2.1	35	4.1	65	49	31	8.4	2940	K32900351_KOJ155
440	85x155	2.0	40	3.4	71	54	34	8.4	3696	K32900441_KOL155
500	85x155	1.9	40	3.4	74	56	35	8.4	4200	K32900501_KOL155

**RATED
VOLTAGE
VDC**

900V

K32 TYPE STANDARD RATINGS

Cap. μF	$\varnothing \times L$ Mm	ESR $\text{m}\Omega$ 10 KHz	ESL nH	Rth $^{\circ}\text{C}/\text{W}$	Ir a.c. A max 10K Hz 40 $^{\circ}\text{C}$	Ir a.c. A max 10K Hz 60 $^{\circ}\text{C}$	Ir a.c. A max 10KHz 75 $^{\circ}\text{C}$	dV/dt V/ μsec	I pk A	PART NUMBER Termination digit excluded
150	75x120	2.4	35	5.2	53	40	25	10.6	1584	K32111151_KOJ120
220	75x140	2.3	35	4.6	56	43	27	9.6	2112	K32111221_KOJ140
220	85x120	2.4	40	4.4	60	45	28	10.6	2323	K32111221_KOL120
250	75x155	2.3	35	4.1	62	47	30	9.6	2400	K32111251_KOJ155
300	85x140	2.5	40	3.9	61	46	29	9.6	2880	K32111301_KOL140
380	85x155	3.0	40	3.4	58	44	28	9.6	3552	K32111381_KOL155

**RATED
VOLTAGE
VDC**

1100V

Cap. μF	$\varnothing \times L$ Mm	ESR $\text{m}\Omega$ 10 KHz	ESL nH	Rth $^{\circ}\text{C}/\text{W}$	Ir a.c. A max 10K Hz 40 $^{\circ}\text{C}$	Ir a.c. A max 10K Hz 60 $^{\circ}\text{C}$	Ir a.c. A max 10KHz 75 $^{\circ}\text{C}$	dV/dt V/ μsec	I pk A	PART NUMBER Termination digit excluded
100	75x120	2.4	35	5.2	53	40	25	12.8	1276	K32131101_KOJ120
150	75x140	2.5	35	4.6	55	42	26	11.6	1740	K32131151_KOJ140
150	85x120	2.5	40	4.4	56	42	27	12.8	1914	K32131151_KOL120
170	75x155	2.5	35	4.1	58	44	28	11.6	1972	K32131171_KOJ155
200	85x140	2.6	40	3.9	58	44	28	11.6	2320	K32131201_KOL140
220	85x155	2.9	40	3.4	61	46	29	11.6	2552	K32131221_KOL155

**RATED
VOLTAGE
VDC**

1300V